

Typical Application:

1. Motorized toys.
2. Motorized plastic models.
3. Hair Dryer.

Weight: 35g (Approx.)

DIRECTION OF ROTATION

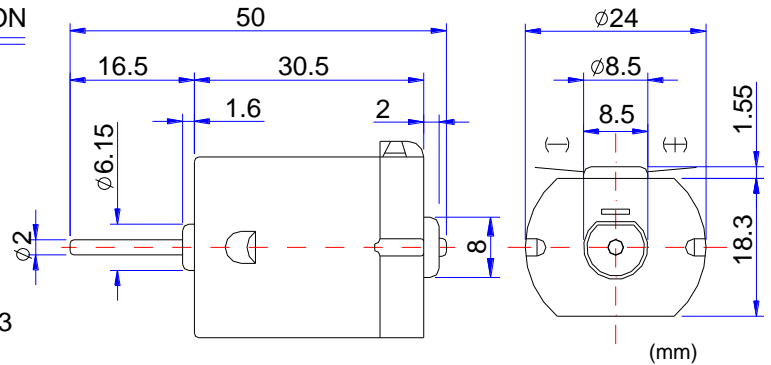
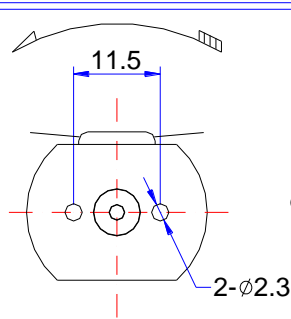

SHEET METAL BRUSH MOTORS AND CARBON BRUSH MOTORS

ELECTRICAL SPECIFICATION CHART: (The following specifications can be changed as customers' requirement)

Model	Voltage		At No Load		At Max Efficiency				Stall
	Workable Range	Nominal	Speed RPM	Current A	Speed RRPM	Current A	Torque G.CM	Output W	Torque G.CM
FC280SM-12310	10.0~15.0V	12V Constant	6,300	0.06	4,940	0.22	28.0	1.40	130
FC280SM-18165	10.0~15.0V	12V Constant	12,400	0.10	10,700	0.51	35.0	3.84	260
FC280SM-20150	10.0~15.0V	12V Constant	13,000	0.10	11,360	0.53	41.00	4.57	305
FC280SM-21130	10.0~15.0V	12V Constant	14,500	0.18	12,100	0.90	50.20	6.20	300
FC280SM-2865	3.0~6.0V	3.0V Constant	6,290	0.28	5,032	0.69	20.0	1.03	100
FC280SM-16200	10~15.0V	12V Constant	10,000	0.07	8,670	0.35	28.7	2.78	220
FC280SM-3150	1.5~3.0V	2.4V Constant	6,900	0.37	5670	1.06	25.0	1.45	140
FC280SM-3550	1.5~3.0V	2.4V Constant	7,100	0.30	5920	1.29	35.0	2.13	210

CHARACTERISTIC CURVES:

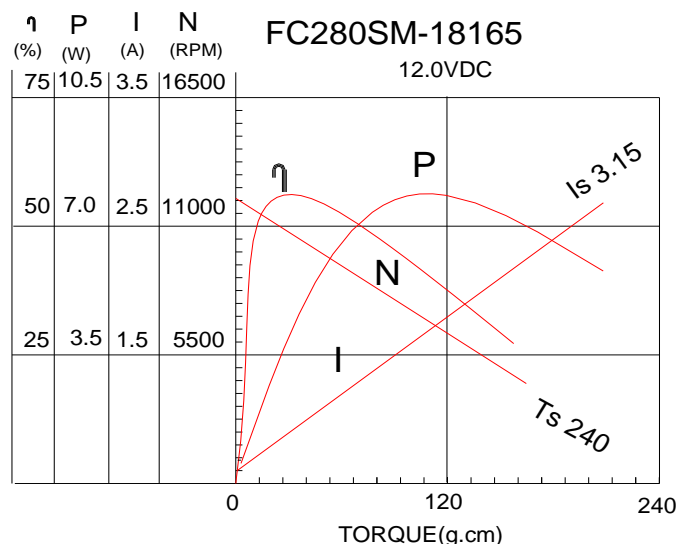
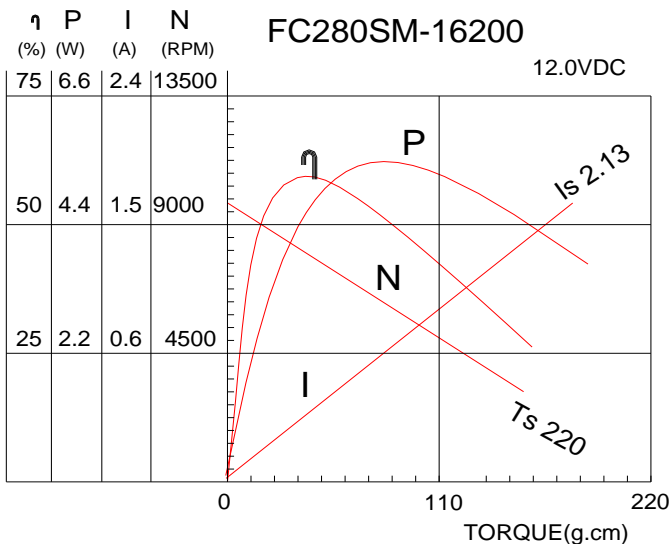

Shenzhen Nostop Electric Co., Ltd

Building C#, Gangzhilong Science & Technology Industrial Park, Qinglong Road, Longhua Town,
Shenzhen City, Guangdong Province, 518107 P.R.China

TEL: +86.755. 2983 4766, 2815 9775, 2815 9776 FAX: +86.755. 2967 4299

E-mail: stony@nostop.cn

URL: <http://www.nostopmotor.com>, <http://www.nostop.cn>