

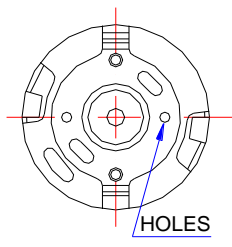
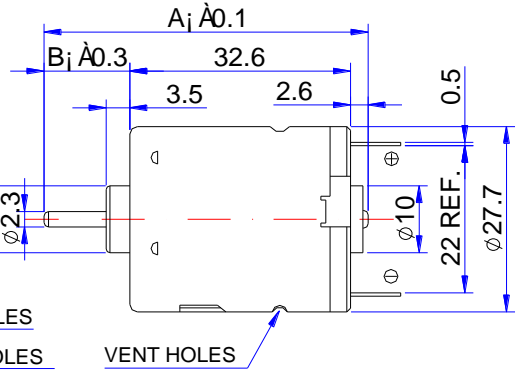
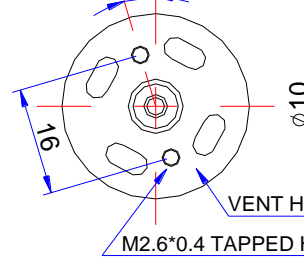
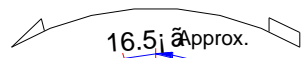

Typical Application:

1. Household Appliances:
 - a) Hairdryer
 - b) Massager
 - c) Vibrator
 - d) Corn Popper
 - e) Air Compressor.
2. Other Applications As Customer's Needs.

DIRECTION OF ROTATION

 Shaft Length (A): 51.0 57.0
 Shaft Extension (B): 15.2 21.1

* Carbon Brush Motor. * Plastic Bottom Cap. Weight: 49g (APPROX)

ELECTRICAL SPECIFICATION CHART: (The following specifications can be changed as customers' requirement)

Model	Voltage		At No Load		At Max Efficiency					Stall Torque G.CM
	Workable Range	Nominal	Speed RPM	Current A	Speed RRPM	Current A	Torque G.CM	Output W	Eff. %	
RC365SM-1885	6.0~20.0	12.0V Constant	13600	0.24	10600	0.88	54.0	5.87	56.0	255
		20.0V Constant	23200	0.24	18900	1.05	65.0	12.60	60.0	380
RC365SM-10200	12.0~28.0	18.0V Constant	8100	0.07	6150	0.22	32.2	2.00	51.0	134
		24.0V Constant	11000	0.08	8650	0.28	42.3	3.70	55.5	192
RC365SM-16120	6.0~26.0	12.0V Constant	9000	0.11	7180	0.43	40.4	3.00	57.3	200
		24.0V Constant	19000	0.15	15650	0.70	65.6	10.50	62.7	372

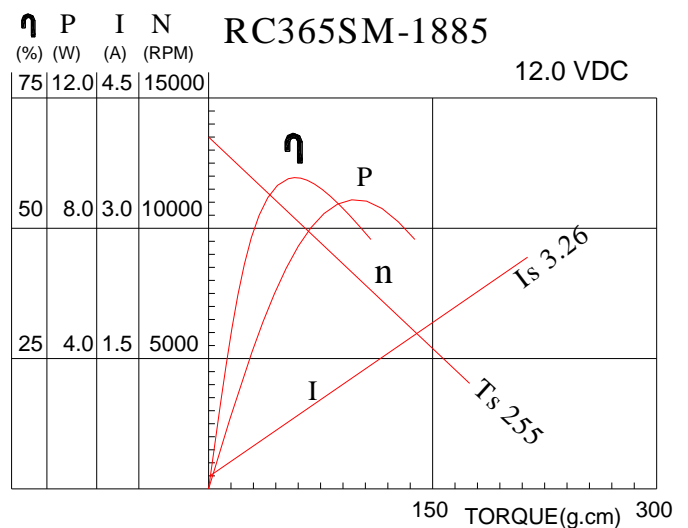
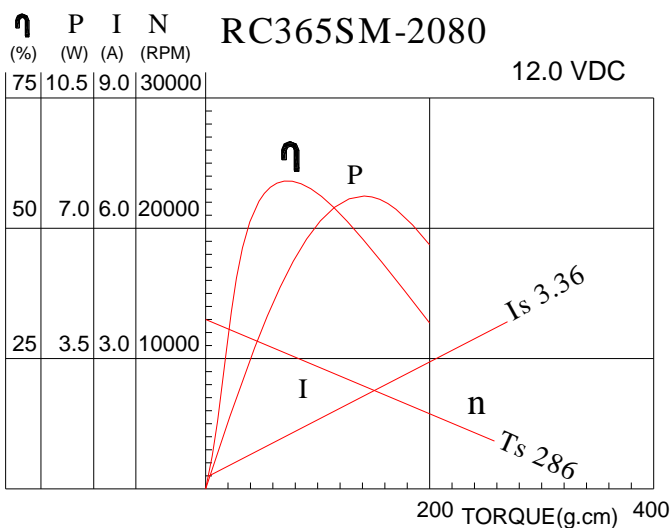
CHARACTERISTIC CURVES:

Shenzhen Nostop Electric Co., Ltd

 Building C#, Gangzhilong Science & Technology Industrial Park, Qinglong Road, Longhua Town,
 Shenzhen City, Guangdong Province, 518107 P.R.China

TEL: +86.755. 2983 4766, 2815 9775, 2815 9776 FAX: +86.755. 2967 4299

 E-mail: stony@nostop.cn

 URL: <http://www.nostopmotor.com>, <http://www.nostop.cn>