



Features:
* Carbon Brush Motor.

Weight:
156g (APPROX)

Typical Application:

1. Vacuum Cleaner/bilge Pump
2. Automatic Cruise Control
3. Car Accessories
4. Lumber Support

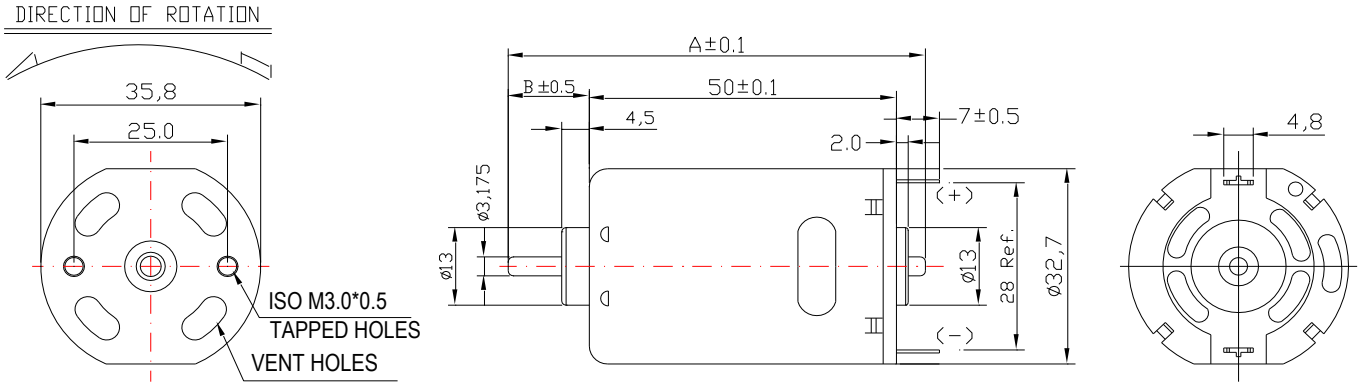

SHAFT LENGTH(A) : 67.0 72.0 80.0
SHAFT EXTENSION(B): 13.0 18.0 26.0

ELECTRICAL SPECIFICATION CHART: (The specifications can be changed as customers' requirement)

Model	Voltage		At No Load		At Max Efficiency					Stall Torque
	Workable Range	Nominal	Speed	Current	Speed	Current	Torque	Output	Eff.	G.CM
			RPM	A	RRPM	A	G.CM	W	%	
RC545S-15220	18~30V	24V Constant	3800	0.08	2988	0.30	140	4.3	59.7	630
RC545S-19170	18~30V	24V Constant	5300	0.12	4340	0.58	200	8.9	63.9	1100
RC545S-2580	18~30V	24V Constant	11500	0.28	9585	1.48	250	24.6	69.3	1500
RC545S-2755	6~24V	12V Constant	7500	0.28	6200	1.26	140	8.9	58.9	800
RC545S-3740	18~30V	12V Constant	23500	0.65	20210	4.15	350	72.5	72.8	2500

CHARACTERISTIC CURVES:

